

PiTAC Gulf (FZC)

**XPS FOAMED
EXTRUSION**



XPS Thermal Insulation Boards

Insulating walls and roofs:

Heat penetrating through walls and roofs forms a great amount that needs to be minimized by cooling systems, hence the importance of Thermal Insulation

Benefits of using Thermal Insulation Sheeting

- Reduce the consumption of electrical energy up to 40% during the cooling process inside the building.
- Increases the level of comfort for the inhabitants in a building as it provides a cooler interior.
- The usage of AC is minimized and so are the loads of AC cables and ducts.
- This helps to reduce the cost of power consumption and electromechanical item's initial cost.
- Protects the building materials from the constant fluctuations in temperature.
- Protects furniture inside the buildings
- Reduces environment pollution and the heat transmitted into the buildings.
- Reduces the level of energy consumption, which helps to minimize the problems caused by excessive loads of generators and the distribution networks and reduces its initial cost.
- Thermally Insulated buildings have less noise pollution from the AC's and chiller rooms as also from the noise penetrating from outside.



PiTAC Gulf



Extruded Polystyrene Insulation (XPS) helps keep homes warm in winter, and cool in summer. Homes are more comfortable, and utility costs are lower.

XPS Thermal Insulation Boards can save up to 40% off your electricity Bill

Our Plant is designed to produce XPS Thermal Insulation Boards by extrusion from polystyrene with different:

Densities ranging from 32 to 50 Kg/m²

This means that we can supply insulation boards to all building industries, please see chart below:-

Application	Strength	Density	
Walls	210kPa		28 – 32
Roof	300kPa		32 – 35
Floor	500kPa		38 – 45

PiTAC Gulf

Our XPS sheeting Plant is divided into two parts:

- *The extrusion line to manufacture of XPS*
- *The recycling Plant*

From experience we have found that all material can be recycled without effecting the product specifications or quality.

The Product Specification

Name	Thermal Insulation Board
Product Density	32 – 50 kg/m ³
Product Length	1250mm (this is variable to suit customers)
Product Width	600mm (this is variable to suit customers)
Product Thickness	25 – 100mm



THE 3 R IN XPS SHEETING

REDUCE
REUSE
RECYCLE

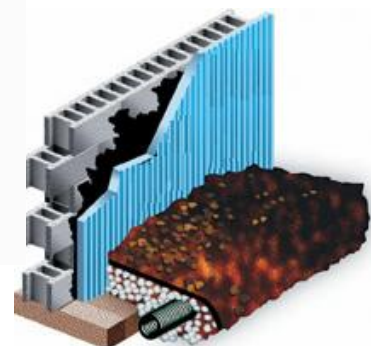

XPS - Benefits

The sustainable benefits of using XPS insulation are numerous, including



- High thermal performance
- Excellent compressive strength
- Condensation control.

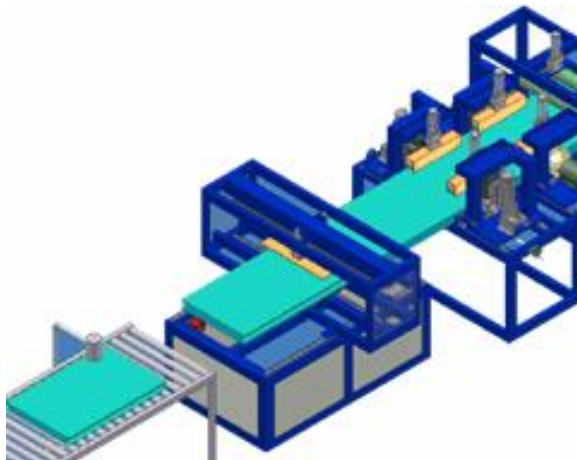

In fact, it is a proven fact that by insulating your home with an investment of just a few hundred dollars, one can reduce heating and cooling needs by about 40%.

Benefits of an XPS energy-efficient residence?
Savings on heating and cooling bills
Moisture control in your home, and reduced incidence of mold and mildew.

Most notably, the thermal insulating properties of XPS provide both energy-efficiency and environmental benefits.

Please Click one for machine specifications:

[Model: PT-300PSB](#) - 300kg/hr or 156,000 sheets per month

[Model: PT-400PSB](#) - 450kg/hr or 234,000 sheets per month

[Model: PT-600PSB](#) - 600kg/hr or 312,000 sheets per month

M.T.P Multi Turnkey Projects (FZC)



Foam Extrusion Technology
XPS Sheeting.....



Model: PT-300PSB		Model: PT-450PSB		Model: PT-600PSB	
Model:	PT-250PSB	Model:	PT-450PSB	Model:	PT-600PSB
Production capacity:	300kg/hr@50mm sheet (max)	Production capacity:	450kg/hr@50mm (max.)	Production capacity:	600kg/hr@50mm (max.)
Sheet width:	600mm (after cutting)	Sheet width:	600mm (after cutting)	Sheet width:)	600mm (after cutting)
Sheet Length:	1250mm	Sheet Length:	1250mm	Sheet Length:	1250mm
Sheet thickness:	25-65mm	Sheet thickness:	25-100mm	Sheet thickness:	25-100mm
Density:	32-50 kg/M3	Density:	32-50 kg/M3	Density:	32-50 kg/M3
Blowing Agent:	Butane / HCFC / HFC	Blowing Agent:	Butane / HCFC / HFC	Blowing Agent:	Butane / HCFC / HFC
Raw Material:	GPPS	Raw Material:	GPPS	Raw Material:	GPPS
Extruder type:	Tandem type	Extruder type:	Tandem type	Extruder type:	Tandem type
Power consumption:	1000KW (max.)	Power consumption:	1200KW (max.)	Power consumption:	1500KW (max.)
Occupation area:	70M(L) x 8M(W) x 5M(H)	Occupation area:	70M(L) x 8M(W) x 5M(H)	Occupation area:	80M(L) x 8M(W) x 5M(H)
Shipping:	40' x 7 (max.)	Shipping:	40' x 7 (max.)	Shipping:	40' x 8 (max.)
Primary Extruder		Primary Extruder		Primary Extruder	
Screw diameter:	120mm	Screw diameter:	130mm	Screw diameter:	150mm
Driving motor:	150HP	Driving motor:	250HP	Driving motor:	300HP
Screw rpm:	120rpm max.	Screw rpm:	120rpm max.	Screw rpm:	120rpm max.
Thermal control:	5 zones	Thermal control:	5 zones	Thermal control:	5 zones
Barrel cooling:	5x air-blower	Barrel cooling:	5x air-blower	Barrel cooling:	5x air-blower
Blowing agent holes:	2 holes	Blowing agent holes:	2 holes	Blowing agent holes:	2 holes
Screen Changer & Connecting tube		Screen Changer & Connecting tube		Screen Changer & Connecting tube	
Thermal control:	2 zones	Thermal control:	2 zones	Thermal control:	2 zones
Screen changer type:	2 holes & honeycomb	Screen changer type:	2 holes & honeycomb	Screen changer type:	2 holes & honeycomb
Hydraulic pump:	3HP	Hydraulic pump:	3HP	Hydraulic pump:	3HP
Pressure sensor:	1 pcs (0-350bar)	Pressure sensor:	1 pcs (0-350bar)	Pressure sensor:	1 pcs (0-350bar)
Secondary Extruder		Secondary Extruder		Secondary Extruder	
Screw diameter:	150mm	Screw diameter:	180mm	Screw diameter:	200mm
Driving motor:	150HP	Driving motor:	200HP	Driving motor:	250HP
Screw rpm:	30rpm max.	Screw rpm:	30rpm max.	Screw rpm:	30rpm max.
Thermal control:	7 zones	Thermal control:	7 zones	Thermal control:	7 zones
Barrel cooling:	6x water cooling	Barrel cooling:	6x water cooling	Barrel cooling:	6x water cooling
Annealing & static mixer:	2 zones thermal control air-blower cooling	Annealing & static mixer:	2 zones thermal control air-blower cooling	Annealing & static mixer:	2 zones thermal control air-blower cooling
Pressure sensor:	1 pcs (0-350bar)	Pressure sensor:	1 pcs (0-350bar)	Pressure sensor:	1 pcs (0-350bar)
Die		Die		Die	
Type:	T-Die	Type:	T-Die	Type:	T-Die
Thermal control:	2 zones by heater 1 zone x Oil temp control 1 zone x Water temp control	Thermal control:	2 zones by heater 1 zone x Oil temp control 1 zone x Water temp control	Thermal control:	2 zones by heater 1 zone x Oil temp control 1 zone x Water temp control
Pressure sensor:	1 pcs (0-350bar)	Pressure sensor:	1 pcs (0-350bar)	Pressure sensor:	1 pcs (0-350bar)
Calibrator		Calibrator		Calibrator	
Working area:	1000mm(W) x 1300mm(L)	Working area:	1000mm(W) x 1300mm(L)	Working area:	1000mm(W) x 1300mm(L)
Temperature:	Oil temperature controller	Temperature:	Oil temperature controller	Temperature:	Oil temperature controller
Take-off unit		Take-off unit		Take-off unit	
Roller width:	1000mm	Roller width:	1000mm	Roller width:	1000mm
Driving motor:	7.5HP	Driving motor:	7.5HP	Driving motor:	7.5HP
Line speed:	0-10M/min.	Line speed:	0-14M/min.	Line speed:	0-18M/min.
Accessories		Accessories		Accessories	
20 HP compressor		30 HP compressor		30 HP compressor	
50 Ton Cooling Tower	for Sec Extruder	50 Ton Cooling Tower	for Sec Extruder	50 Ton Cooling Tower	for Sec Extruder
Chiller	for Gas Pump	Chiller	for Gas Pump	Chiller	for Gas Pump
Printing Unit		Printing Unit		Printing Unit	
HCFC / HFC gas Tank		HCFC / HFC gas Tank		HCFC / HFC gas Tank	
Butane Gas Tank		Butane Gas Tank		Butane Gas Tank	
10 Ton Cooling Tower	for Recycling Machine	10 Ton Cooling Tower	for Recycling Machine	10 Ton Cooling Tower	for Recycling Machine
Recycling Machine - 100k/hr		Recycling Machine - 100k/hr		Recycling Machine - 200k/hr	
2 stages type	extrusion & Crusher build-in	2 stages type	extrusion & Crusher build-in	2 stages type	extrusion & Crusher build-in
	Crushing unit		Crushing unit		Crushing unit
	Feeding unit		Feeding unit		Feeding unit
	Main Extruder		Main Extruder		Main Extruder
	Sub-extruder		Sub-extruder		Sub-extruder
	Screen-Changer		Screen-Changer		Screen-Changer
	Water Bath		Water Bath		Water Bath
	Granulator		Granulator		Granulator
	Blower		Blower		Blower
	Pellet storage tank		Pellet storage tank		Pellet storage tank

SHEETING SPECIFICATIONS:

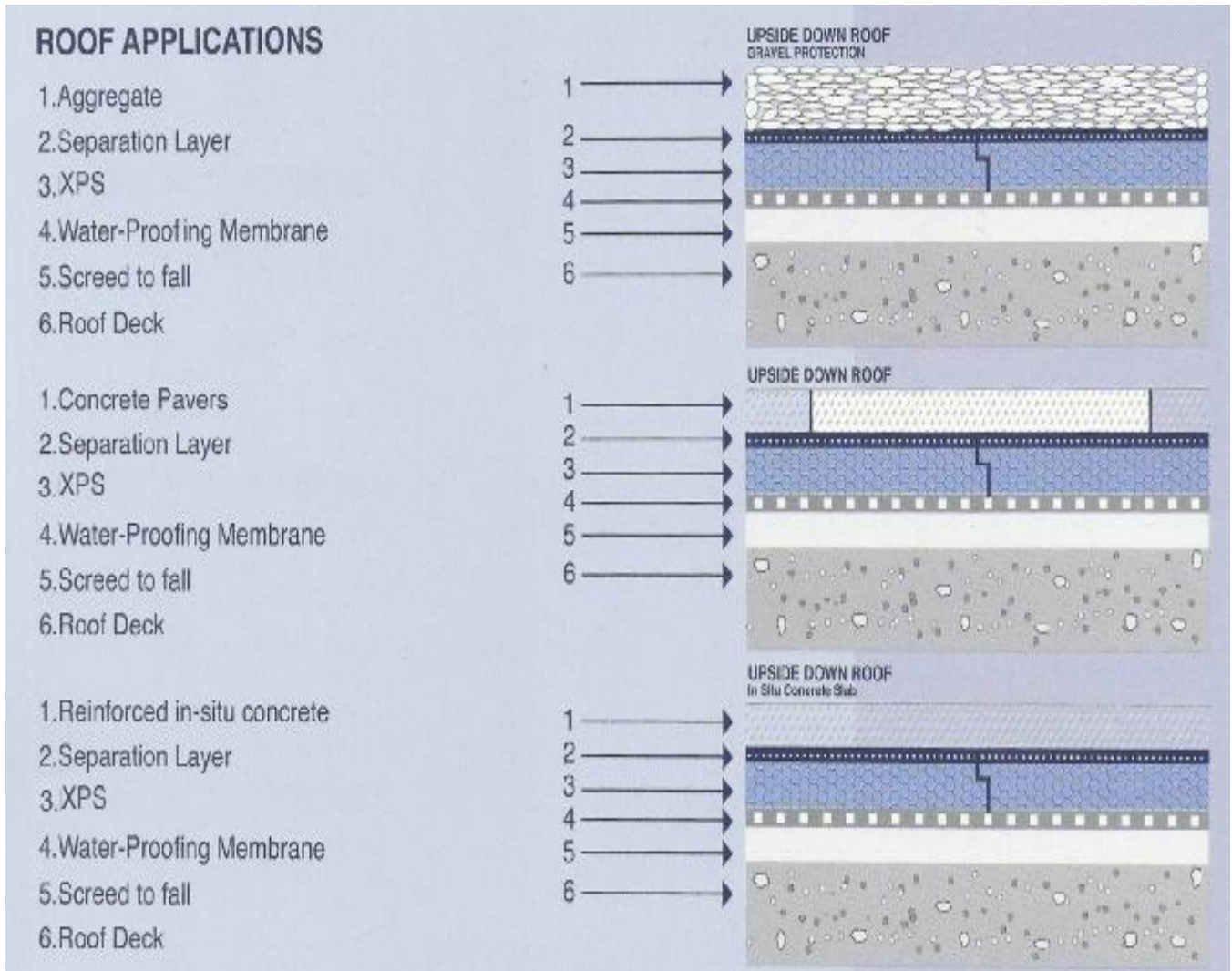

Compressive Strength: Excelled strength for structural applications involving continuous high compressive loads, non-uniform loads of high temperatures.

Resistance to Water penetration: XPS has a structure that consists of small sizes closed cells and a outer skin of foam. This allows it to remain dry in high humidity and cold temperatures areas.

Chemical Resistance: XPS has excellent resistance to acids, basis cold bitumen & silicon oils.

Installation: XPS sheeting can be worked with any conventional tooling. Sheeting is glued together by either a hot bitumen or an adhesive.

Storage: When outdoor storage is demanded sheeting should be protected from UVL, by covering with sheeting.

PiTAC Gulf

Compressive Strength: Excelled strength for structural applications involving continuous high compressive loads, non-uniform loads of high temperatures.

Resistance to Water penetration: XPS has a structure that consists of small sizes closed cells and a outer skin of foam. This allows it to remain dry in high humidity and cold temperatures areas.

Chemical Resistance: XPS has excellent resistance to acids, basis cold bitumen & silicon oils.

Installation: XPS sheeting can be worked with any conventional tooling. Sheeting is glued together by either a hot bitumen or an adhesive.

Storage: When outdoor storage is demanded sheeting should be protected from UVL, by covering with sheeting.



PROPERTIES OF XPS SHEETING

Property	Standard	XPS
Density	Din 53420 ASTM D-1622	32-35Kg/m ³ 2-2.2lb/ft ³

Thermal Conductivity

@ 10° C (50F) mean Temperature	ASTM C-177	0.029 W/mK 0.21 Btuin/ft ² .hr.F
5 Years aged @ 24 ° C (75F) mean	ASTM C-518	0.032 W/mK 0.22 Btuin/ft ² .hr.F
Compressive strength @ 10% def	DIN 53421 ASTM D-1621-73	300 KPa 43 psi
Water vapour resistance	DIN 52615	100-200 μ
Water vapour permeability	ASTM C-355-64	0.4-0.6 Perm inch
Water absorption	DIN 53428 ASTM D-2842	0.2% by vol. <1.00% by vol.
Capillarity		None
Linear coefficient of expansion & contraction		70x10 ⁻⁶ C ^{o-1} 39x10 ⁻⁶ F ⁻¹
Flammability	DIN 4102	B1

Contact Us

Contact:

Hans Rostek
Gunter Rostek
Abdul Wahab

Mobil

+971504814162
+971508418969
+971506390255

Email

pitac52@eim.ae
grostek@yahoo.de
amoy25@eim.ae



PiTAC Gulf

Office:

P.O.Box 8338, SAIF - Sharjah. UAE

Phone: +971 6 5596311

Fax: +971 6 5596310